



# 2023 GN-Carer & GN-Share User manual

Compatible with Glunovo i3 & p3 CGMS

- #1** Apps and Software Overview (page 3-7)
- #2** GN-Share Introduction (page 8-14)
- #3** GN-Carer Introduction (page 15-22)
- #4** Q&A

#1

# Glunovo Apps & Software Overview

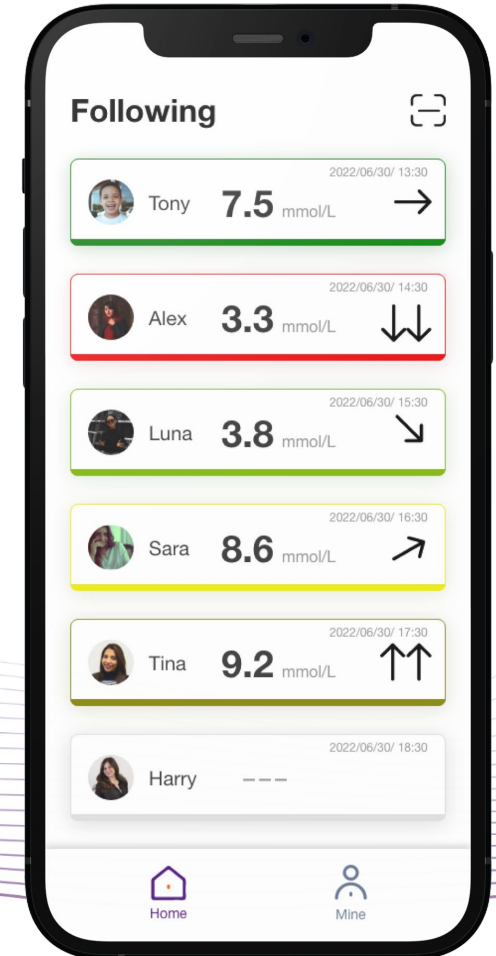
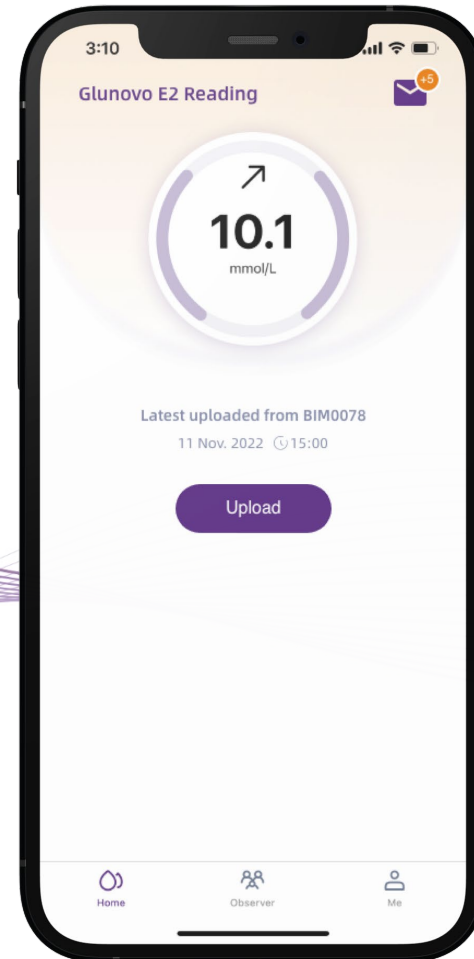

# #1 Apps Overview (Last update: 2022.12.23)



Glunovo



Glunovo E2

## Glunovo App V1.3.14

- Get the signal from the transmitter
- Display and analyze the data
- It's an offline App



## GN-Share App V1.4.0

- Get data from Glunovo App
- Sync to the cloud
- Manage the observer list



## GN-Carer App V1.0.5

- Get data from Cloud
- Remotely observes the one you cares
- Customized alarm for each patient

# #1 Download the apps



If you cannot download the apps,  
please contact customer service

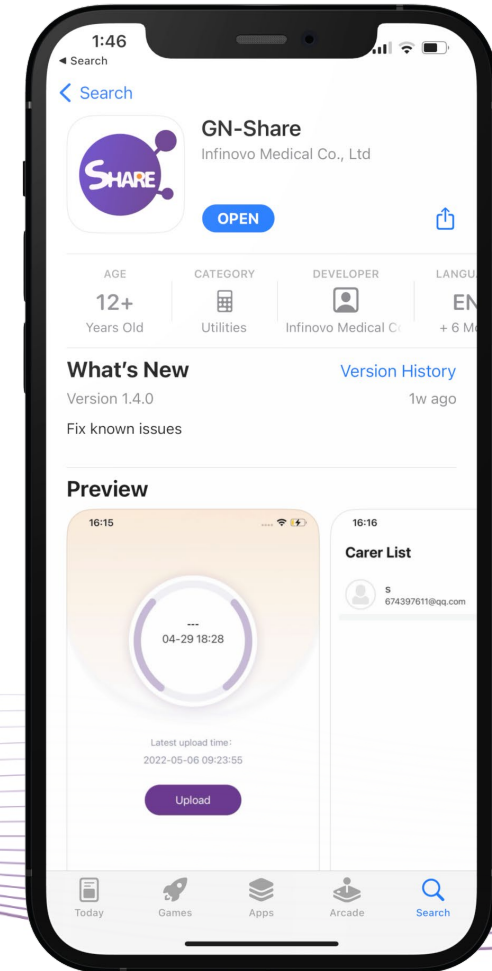
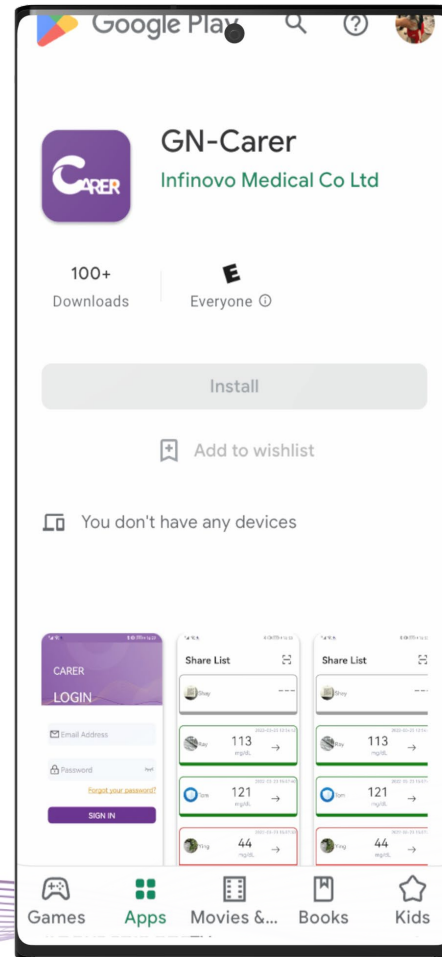

# #1 How to set language?

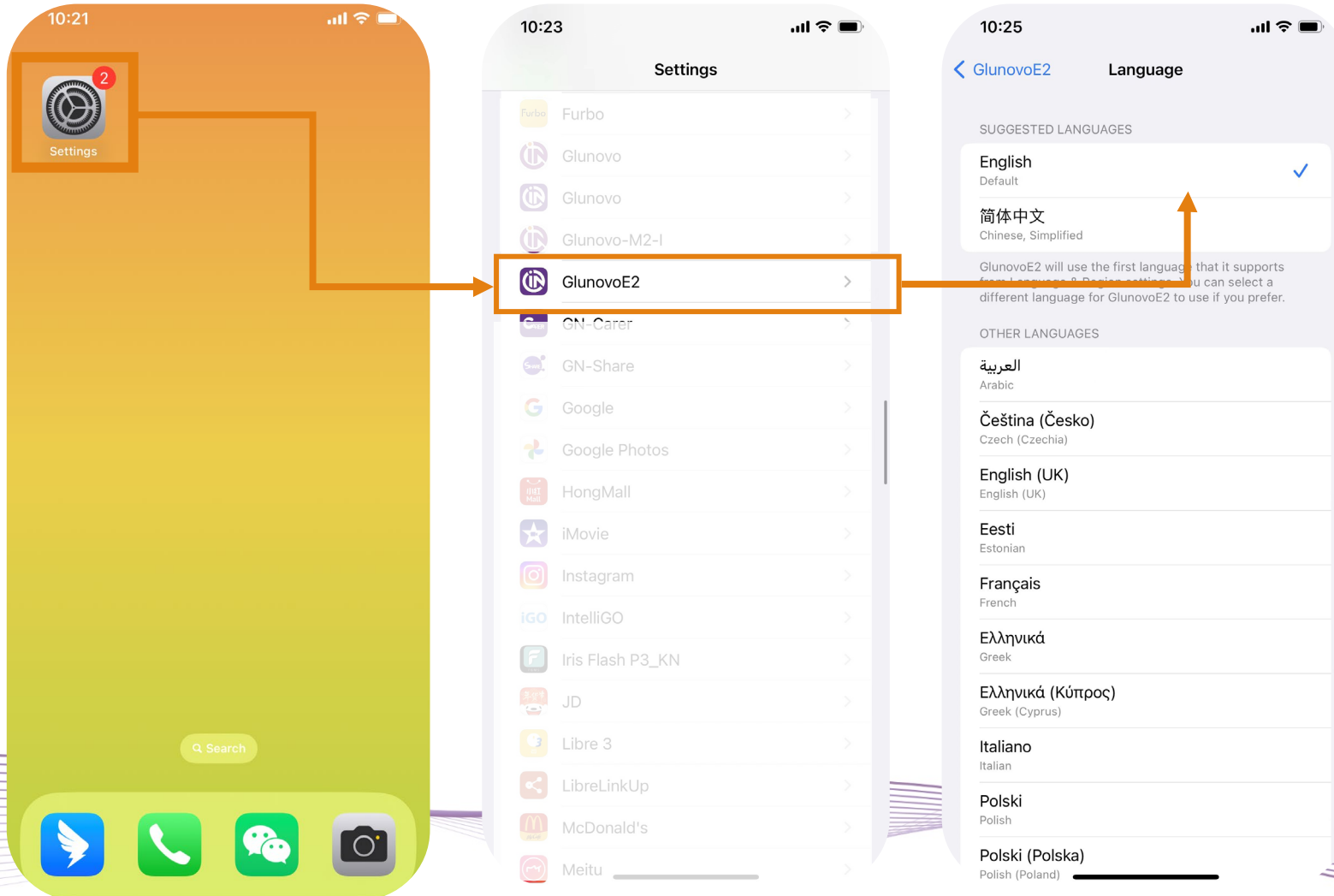

## iOS

The App language is the same with the system.

If you want to change the language please follow the below steps:

1) Got to settings->App->Language

#2

## GN Share Introduction



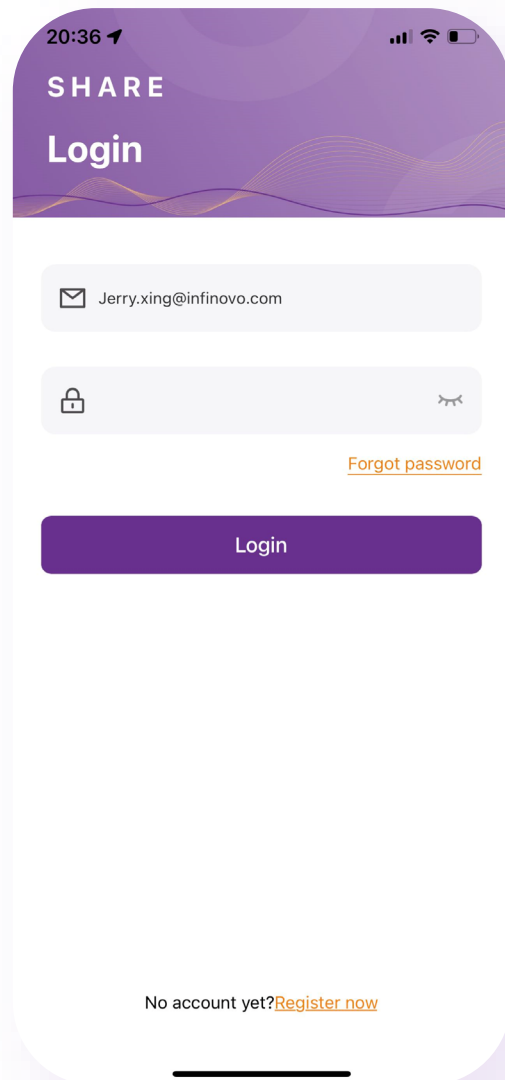

- If you already have an account you can log in with your Share account.
- If you don't have an account , you can click on the Register now to register an account.



## #2 GN-Share –Reset password

You can reset your password  
Using your E-mail address.

1. Click on Forget Password
2. Enter your Email address
3. Get the code from your E-mail  
Fill in the code
4. Reset the password and log in  
again

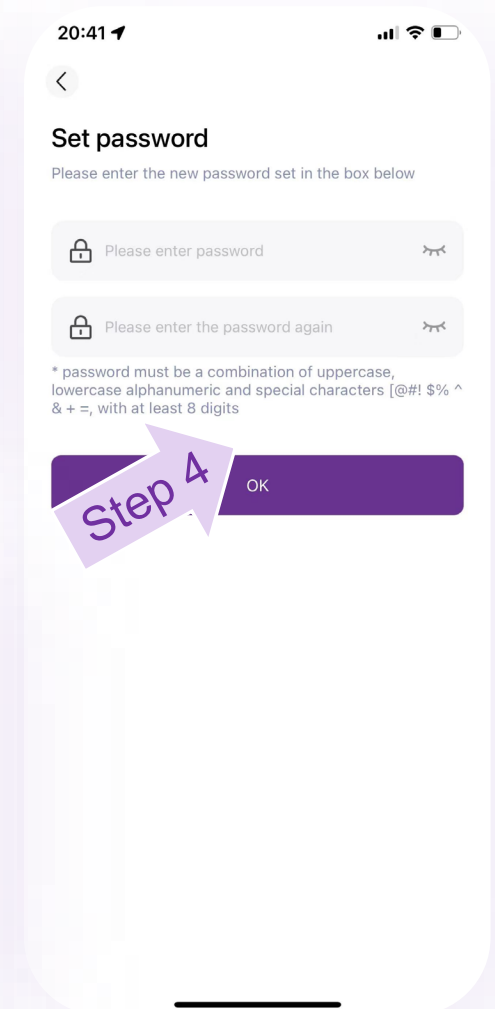
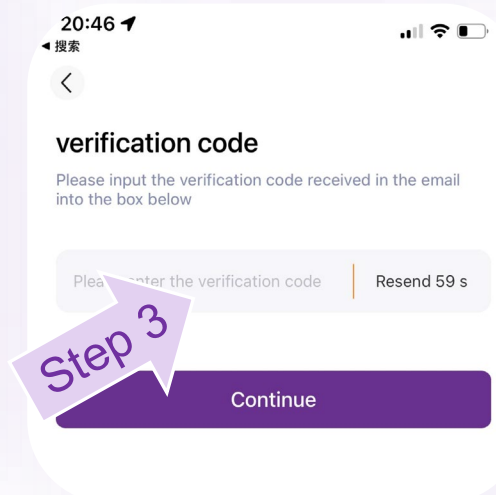
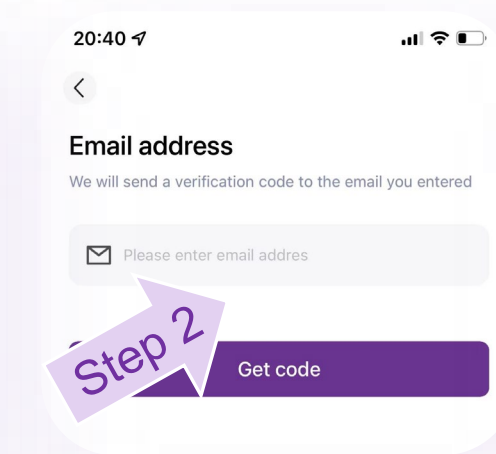
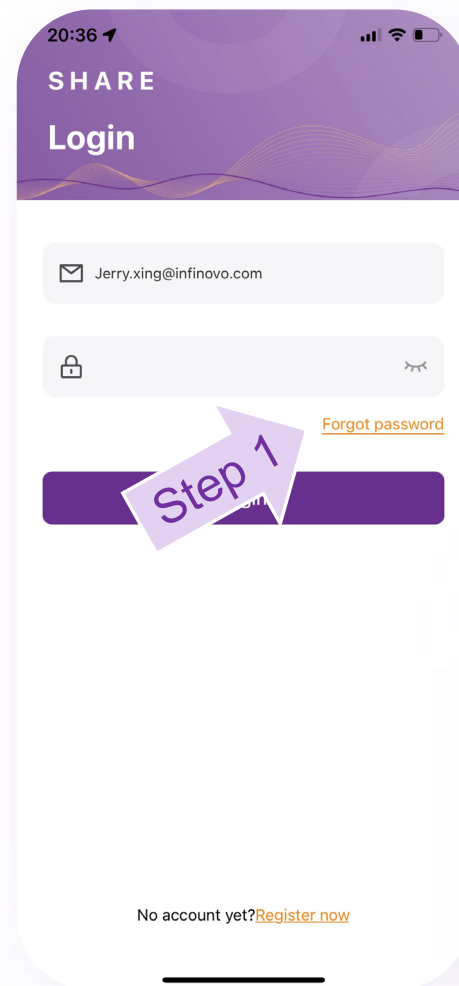

1. Click on Register now in the log in page
2. select your country
3. Fill in the E-mail address
4. Click on get code
5. Fill in the code you get from your E-mail
6. Set the password
7. And click on Register now.

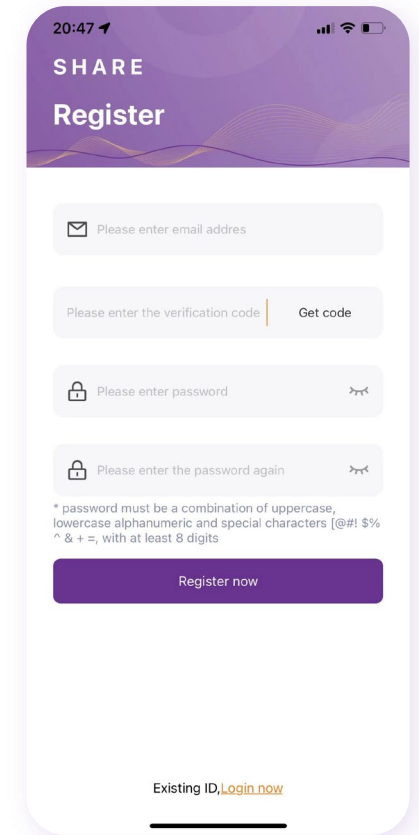
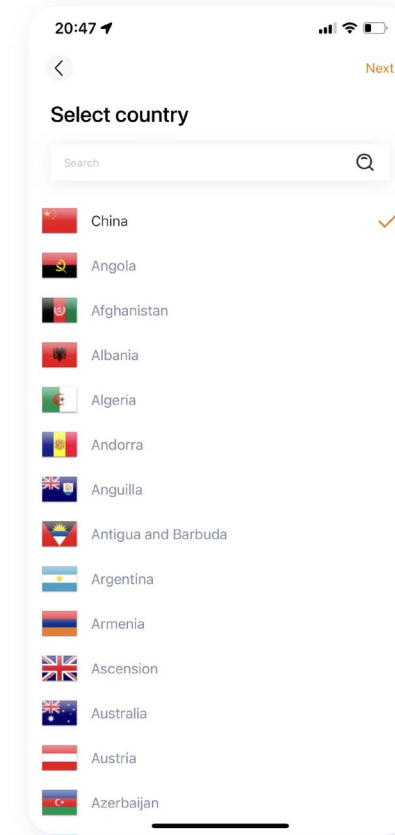
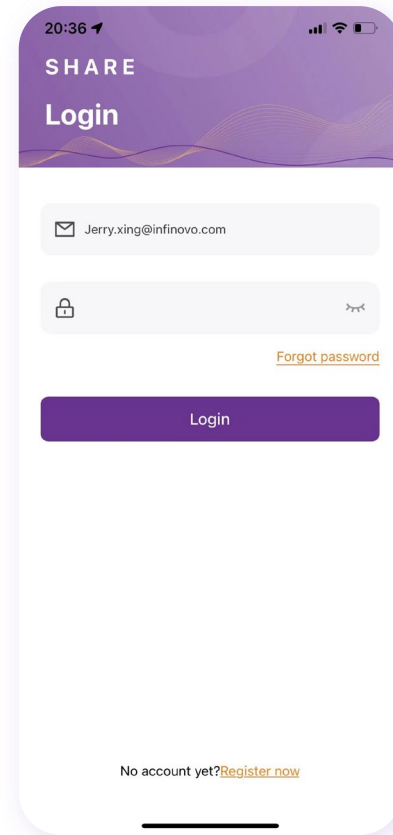

Upload automatically every 3 mins

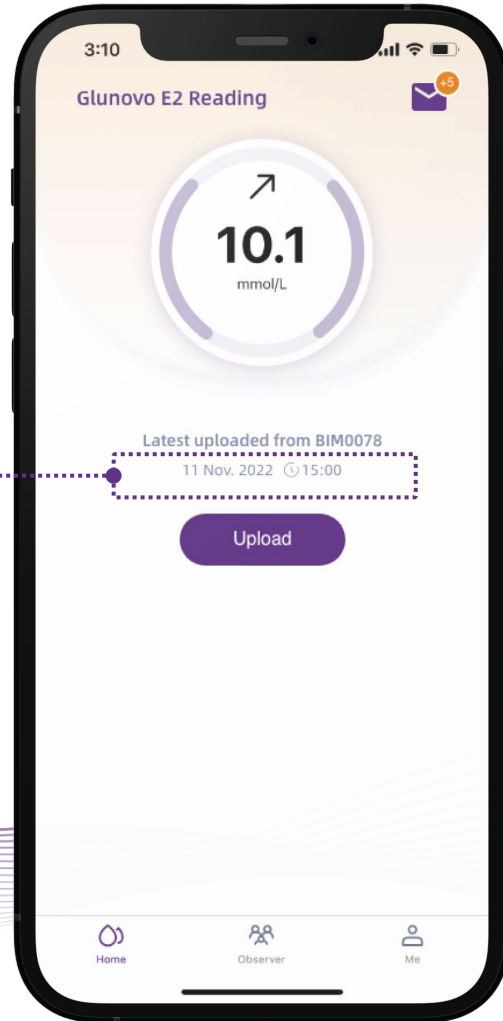



# #2 Add an observer

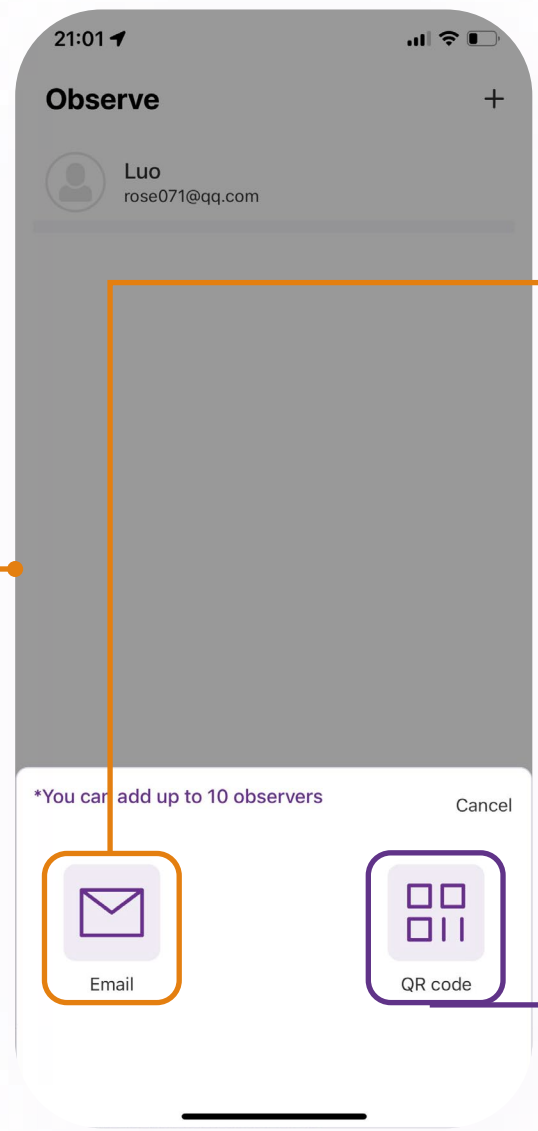
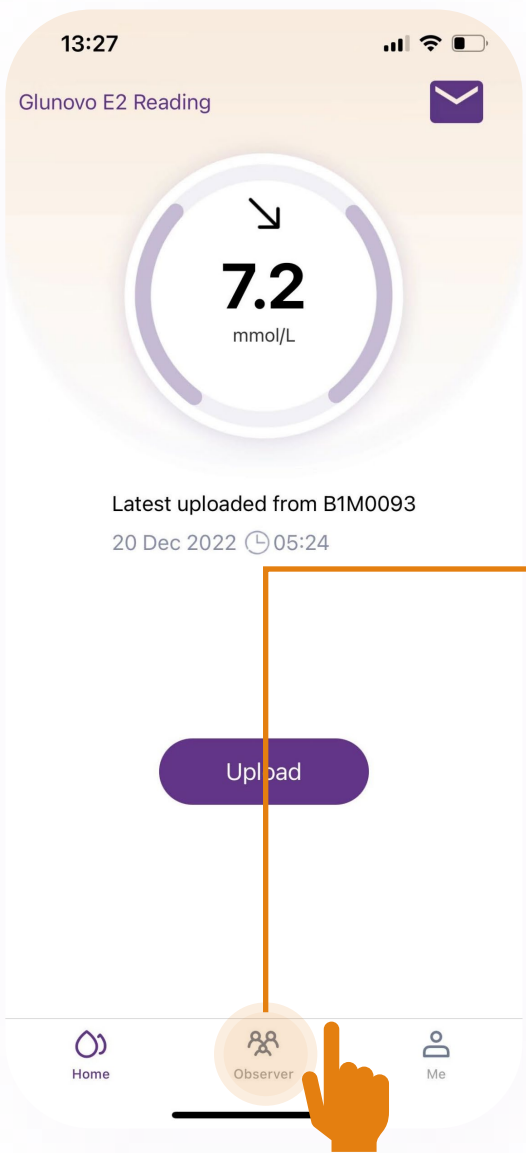

**Add by mail:**  
input your observer's E-mail address and wait for the acceptance. Make sure that the observer already registered a Carer Account.

**Add by QR code:**  
Sent the QR code to your observer/Scan the QR Code face to face and wait for the acceptance.



# #2 Set personal information

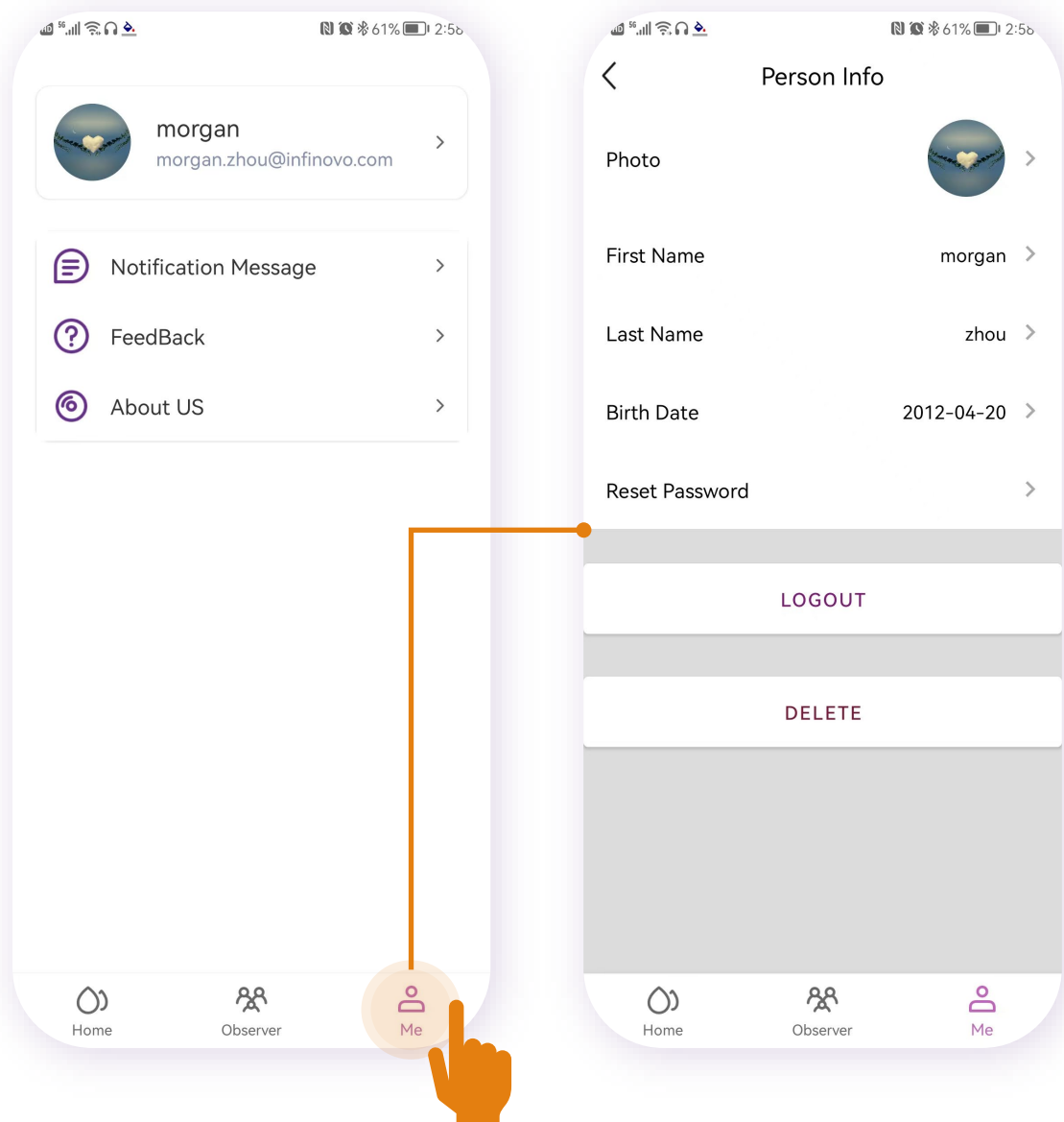

## Go to Mine you can

- Set up your personal information
- Change your profile picture
- Manage your links

**#3**

## **GN Carer Introduction**





# #3 Login Screen

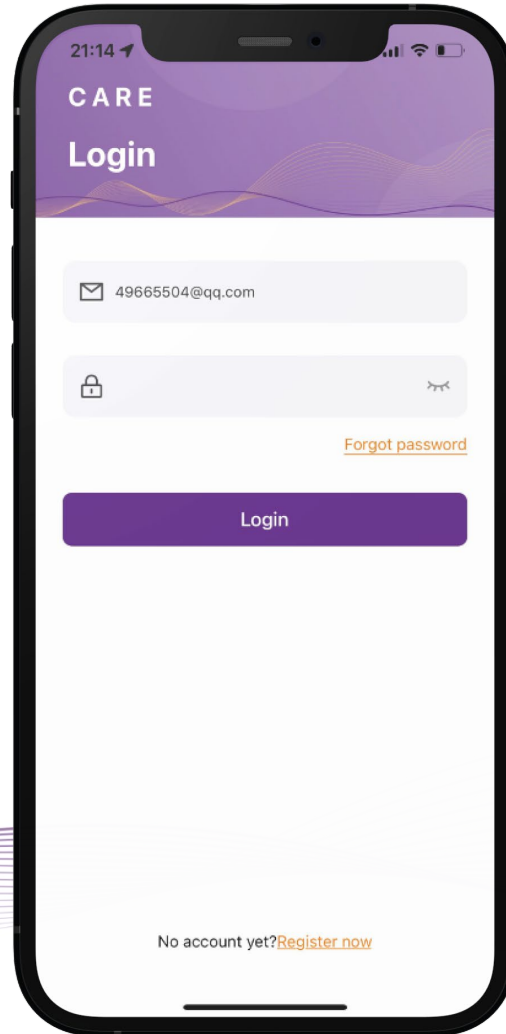



# #3 Login Screen

Next

Please select your country

China  
Angola  
Afghanistan  
Albania  
Algeria  
Andorra  
Anguilla  
Antigua and Barbuda  
Argentina  
Armenia  
Ascension

CARER

## Sign up

Email Address

Verification code | Send

Password

Confirm Password

\*The password must contain at least eight characters, including uppercase letters, lowercase letters, digits, and special characters [@\$%^&+=]

SIGN UP

Existing account [sign in](#)

Skip

## Data entry

Please complete your information

First Name

Last Name

Birth Date

SUBMIT

## Share List

2022-05-07 15:28:25

morgan 6.9 mmol/l →

Home Settings





# #3 Following List

Tab to see the detail

Color Frame:  
Red: Urgent  
Green :Normal  
Yellow: Abnormal

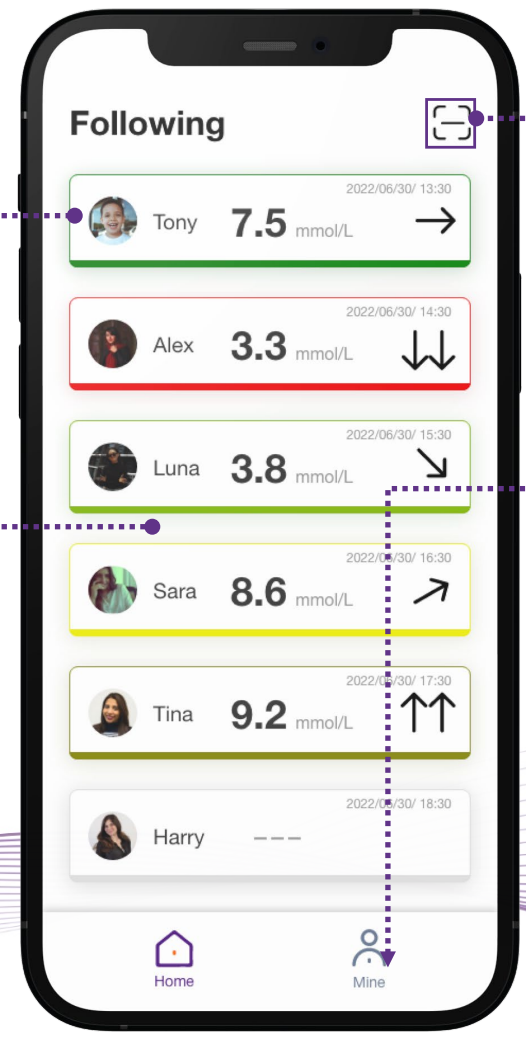

Scan to add new patient

Personal Information



# #3 Following List

**Can NOT be used for Medical Decisions!**

Display data in recent 4 hours

Move to see detail

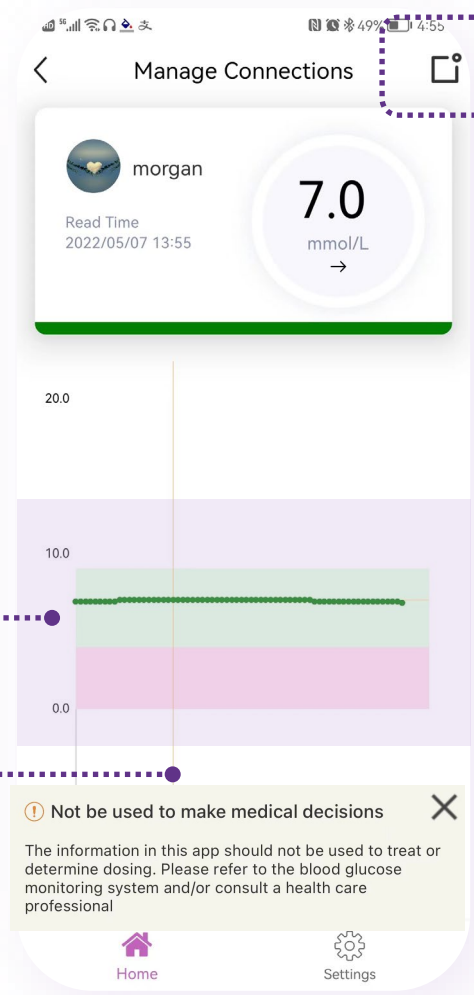

Set Alarm

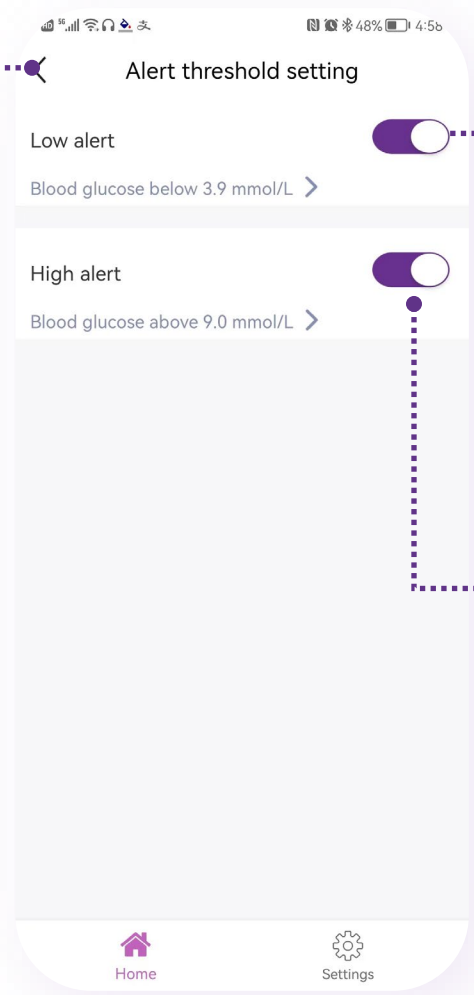

Turn on alarm

Adjust Alarm

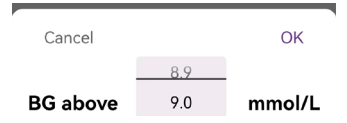



# #3 Manage Contacts

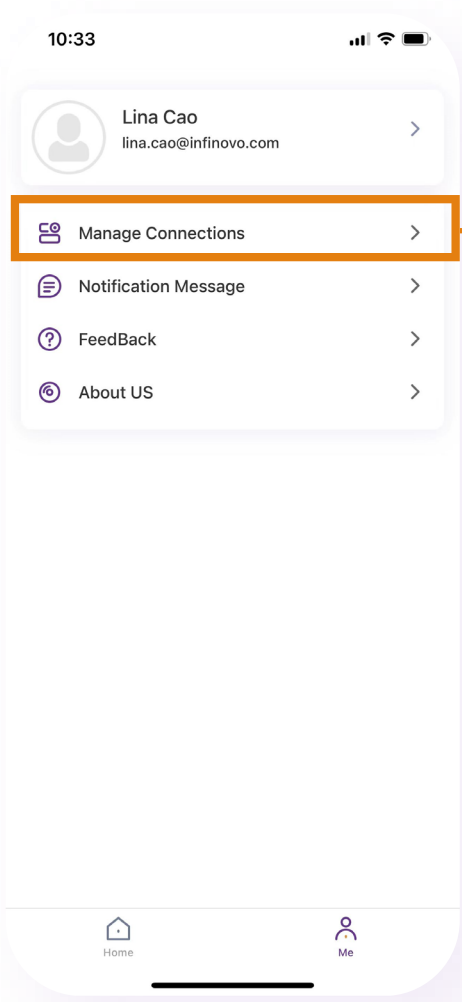

Tab

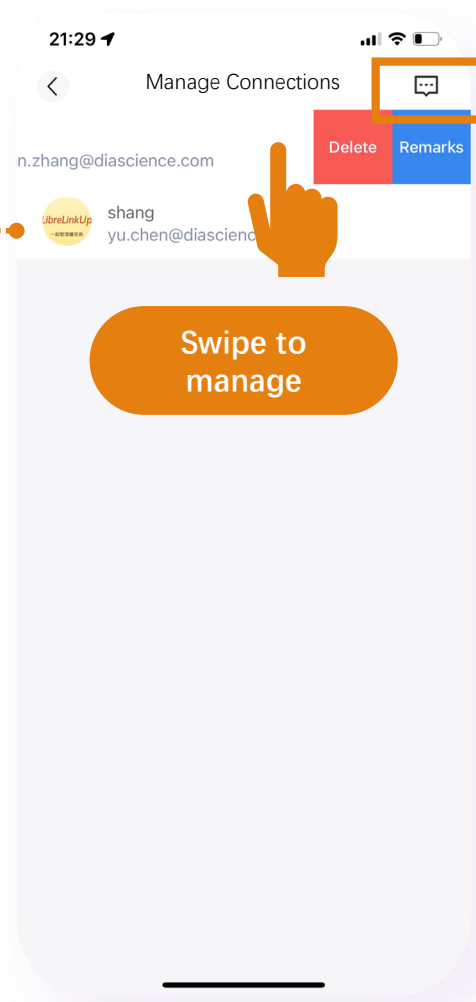

Swipe to manage

History Notifications

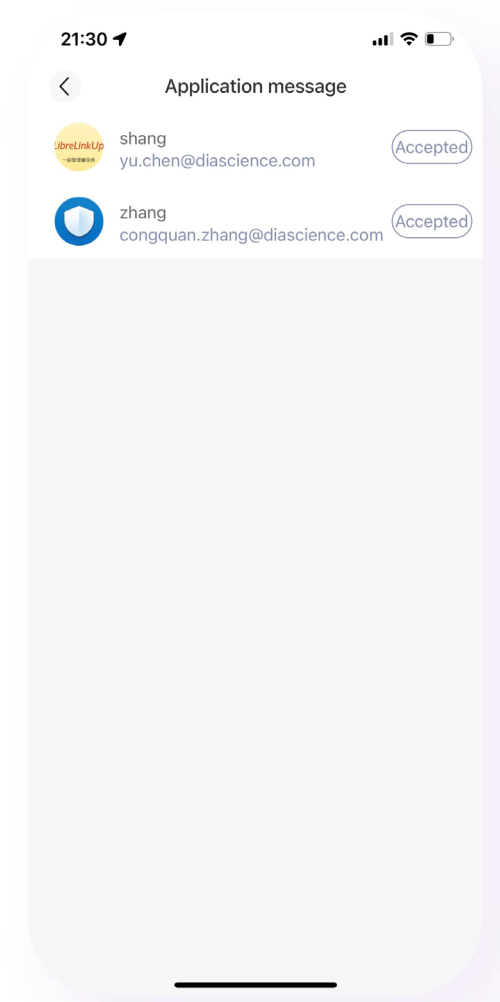



# #3 Notifications & Messages Setting

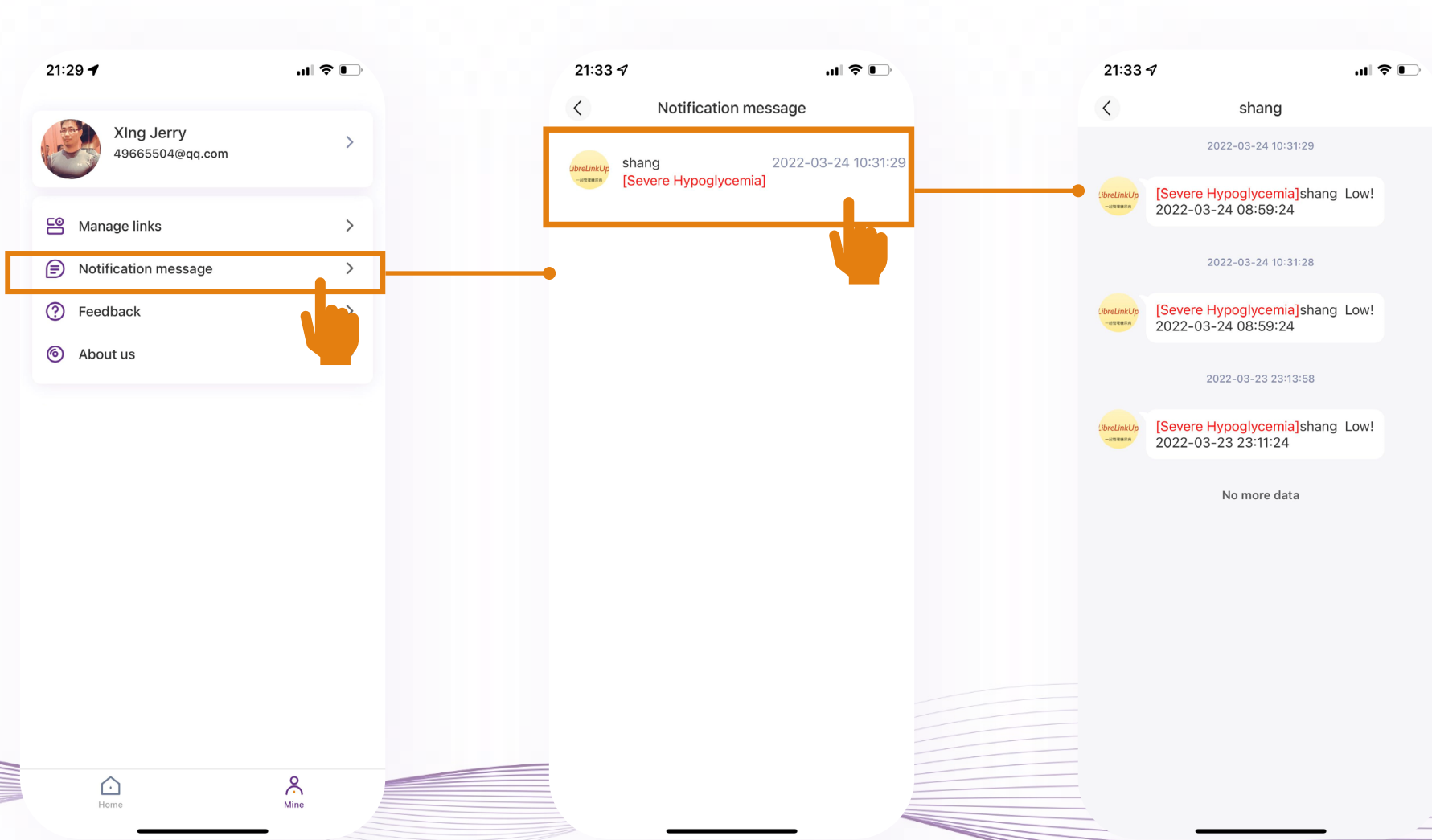



# #3 Scan QR Code to add a patient

**Following**

	Tony	7.5 mmol/L	→	2022/06/30/ 13:30
	Alex	3.3 mmol/L	↓↓	2022/06/30/ 14:30
	Luna	3.8 mmol/L	↘	2022/06/30/ 15:30
	Sara	8.6 mmol/L	↗	2022/06/30/ 16:30
	Tina	9.2 mmol/L	↑↑	2022/06/30/ 17:30
	Harry	---		2022/06/30/ 18:30

Home Mine

10:18

Cancel

Scan the QR code and link with me

9:41

**Tina**  
TINA ts@outlook.com

Add

9:41

**Tina**  
TINA ts@outlook.com

Confirm to add Tina

Cancel Confirm